



# Instruction Manual



**CoComelon™**



**JJ's House Track Set**



**VTech understands that a child's needs and abilities change as they grow and with that in mind we develop our toys to teach and entertain at just the right level...**

## **vtech** Baby

**Toys that will stimulate their interest in different textures, sounds and colours**

### **I am...**

...responding to colours, sounds and textures

...understanding cause and effect

...learning to touch, reach, grasp, sit-up, crawl and toddle

**Birth-36 months**



## **Pre-School**

**Interactive toys to develop their imagination and encourage language development**

### **I want...**

...to get ready for school by starting to learn the alphabet and counting

...my learning to be as fun, easy and exciting as can be

...to show my creativity with drawing and music so my whole brain develops

**3-6 years**



## **Electronic Learning Computers**

**Cool, aspirational and inspiring computers for curriculum related learning**

### **I need...**

...challenging activities that can keep pace with my growing mind

...intelligent technology that adapts to my level of learning

...National Curriculum based content to support what I'm learning at school

**4-10 years**



To learn more about this and other VTech® products, visit [www.vtech.co.uk](http://www.vtech.co.uk)

# INTRODUCTION

Thank you for purchasing the **CoComelon™ Toot-Toot Drivers® JJ's House Track Set**.

Hop into the family car with JJ and take a fun ride around the house! Slide down the ramp tracks for fun, park in the garage, or drive right up to the front door. Interactive **SmartPoint™** locations activate fun songs, sounds and phrases as JJ cruises around.

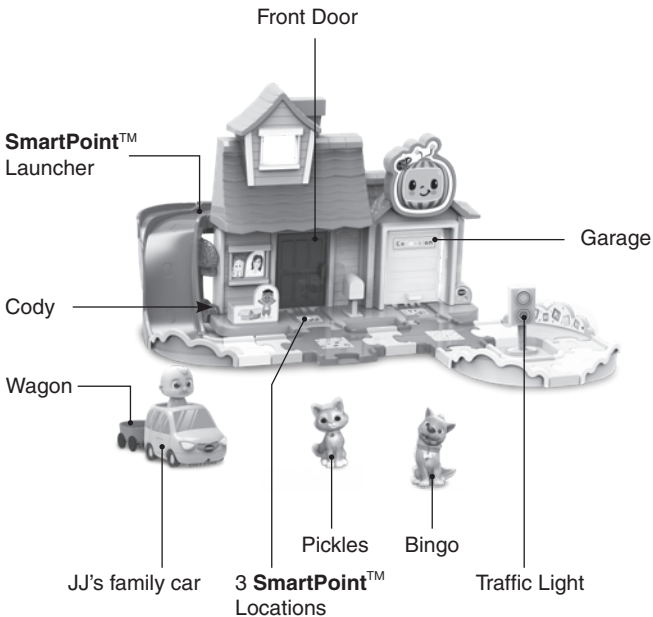

# INCLUDED IN THE PACKAGE



JJ's family car



Pickles



Bingo



One traffic light



A



B



C



D



E



F

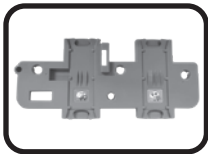

G



H



I



J



K



L

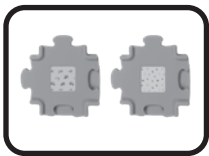

M

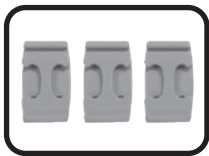

N



O



P

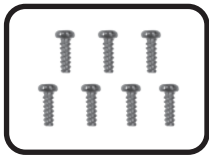

Q

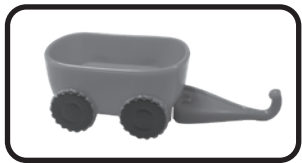

R

- One sticker sheet
- One Quick Start Guide

**WARNING:**

All packing materials such as tape, plastic sheets, packaging locks, removable tags, cable ties, cords and packaging screws are not part of this toy, and should be discarded for your child's safety.

**NOTE:**

Please save this manual as it contains important information.

**CAUTION:**

Adult assembly required. This package contains small screws. For your child's safety, do not let your child play with the toy until it is fully assembled.

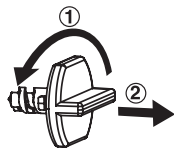
**Removing the Packaging Locks:**

- ① Turn the packaging locks anticlockwise several times.
- ② Pull out the packaging locks and discard.

# GETTING STARTED

## Battery Removal and Installation

### JJ's Family Car

1. Make sure the unit is turned **Off**.
2. Locate the battery cover on the bottom of the vehicle. Use a screwdriver to loosen the screw and then open the battery cover.
3. If used batteries are present, remove these batteries from the unit by pulling up on one end of each battery.
4. Install 2 new AAA (AM-4/LR03) batteries following the diagram inside the battery box. (For best performance, alkaline batteries or fully charged Ni-MH rechargeable batteries are recommended).
5. Replace the battery cover and tighten the screw to secure.

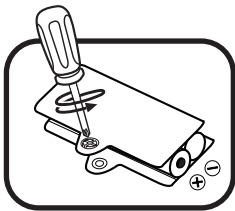

### **WARNING:**

Adult assembly required for battery installation.  
Keep batteries out of reach of children.

### **IMPORTANT: BATTERY INFORMATION**

- Insert batteries with the correct polarity (+ and -).
- Do not mix old and new batteries.
- Do not mix alkaline, standard (carbon-zinc) or rechargeable batteries.
- Only batteries of the same or equivalent type as recommended are to be used.
- Do not short-circuit the supply terminals.
- Remove batteries during long periods of non-use.
- Remove exhausted batteries from the toy.
- Dispose of batteries safely. Do not dispose of batteries in fire.

## RECHARGEABLE BATTERIES

- Remove rechargeable batteries (if removable) from the toy before charging.
- Rechargeable batteries are only to be charged under adult supervision.
- Do not charge non-rechargeable batteries.

## Disposal of batteries and product



The crossed-out wheellie bin symbols on products and batteries, or on their respective packaging, indicates they must not be disposed of in domestic waste as they contain substances that can be damaging to the environment and human health.



The chemical symbols Hg, Cd or Pb, where marked, indicate that the battery contains more than the specified value of mercury (Hg), cadmium (Cd) or lead (Pb) set out in the Batteries and Accumulators Regulation.

The solid bar indicates that the product was placed on the market after 13th August, 2005.



Help protect the environment by disposing of your product or batteries responsibly.

VTech® cares for the planet.

Care for the environment and give your toy a second life by disposing of it at a small electricals collection point so all its materials can be recycled.

In the UK:

Visit [www.recyclenow.com](http://www.recyclenow.com) to see a list of collection points near you.

In Australia & New Zealand:

Check with your local council for kerbside collections.



# LABEL APPLICATION

Please securely place the stickers on the track set as indicated on the following pages below:

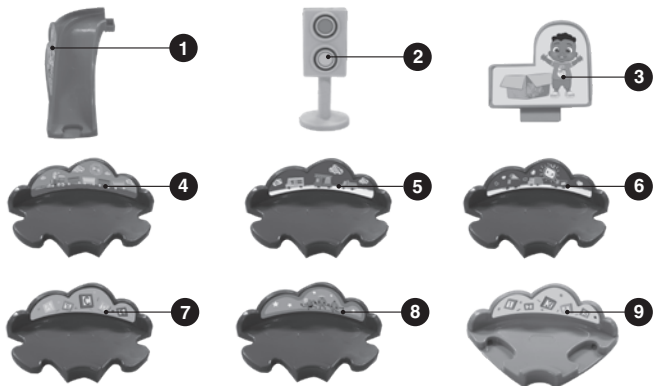
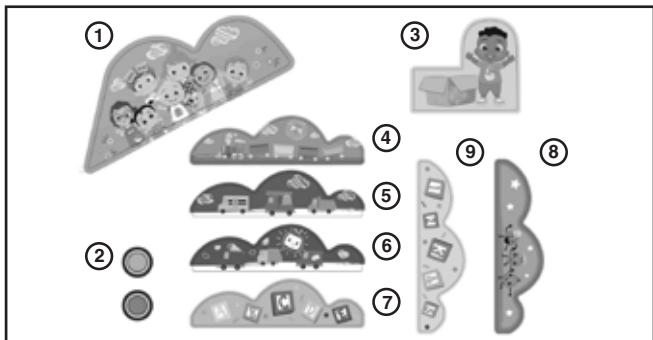

# ASSEMBLY INSTRUCTIONS

With the CoComelon™ Toot-Toot Drivers® JJ's House Track Set, safety comes first. Adult assembly is required. For your child's safety, do not let them play with this toy until it is fully assembled.

1. Insert B into A, then tighten one screw to secure as shown below.

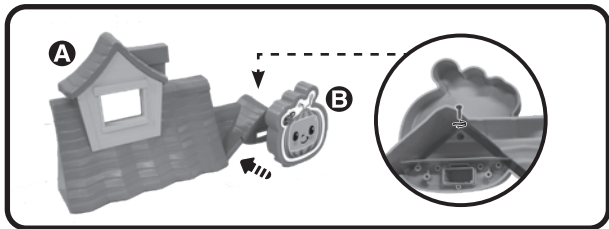

2. Connect C and A as shown below, then tighten six screws to secure as shown below.

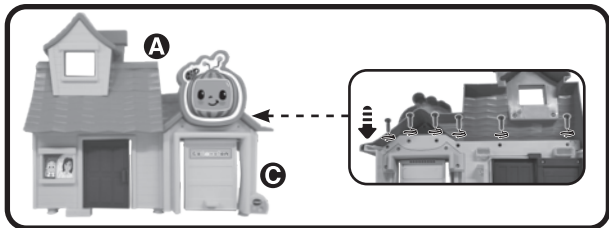

3. Snap D into C as shown below.

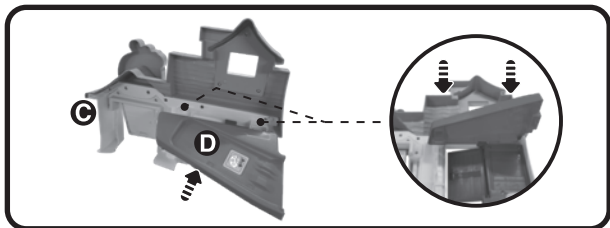

4. Snap C into G as shown below.



5. Snap E into D as shown below.

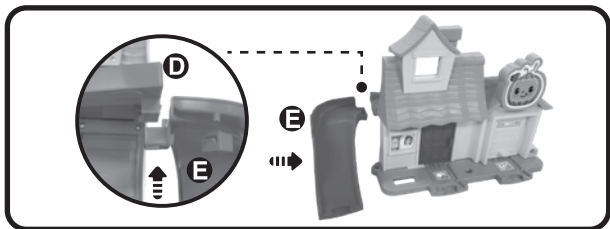

6. Snap F into E and G as shown below.

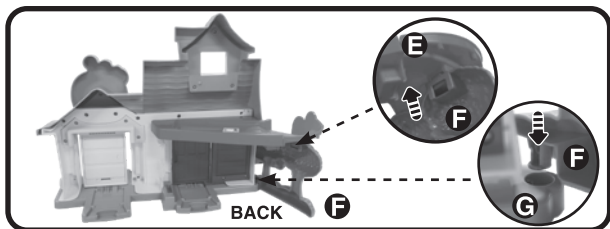

7. Attach H to D and G as shown below.

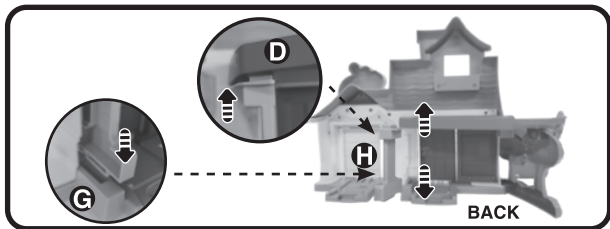

8. Snap I and J into G as shown below.



9. Connect the track pieces in the front and back of house as shown below.

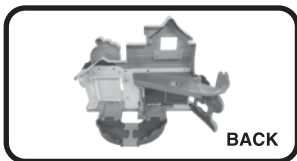
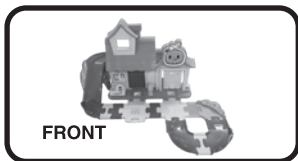

10. Insert the **Wagon** into the base of the **JJ's Family Car** as shown below, and place the accessories as desired, then **JJ's House Track Set** is ready to play!



# PRODUCT FEATURES

## JJ's Family Car

### 1. On/Off Switch

To turn the unit **On**, slide the **On/Off Switch** to the **On** (⏻) position. To turn the unit **Off**, slide the **On/Off Switch** to the **Off** (●) position.

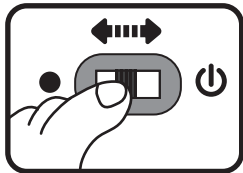

### 2. Automatic Shut-Off

To preserve battery life, **JJ's Family Car** will automatically power down after approximately 60 seconds without input. The unit can be turned on again by pressing the JJ character button or triggering a **SmartPoint™** location.

**Note:** This product is in Try-Me mode in the packaging. After opening the package, turn the vehicle off and on again to proceed with normal play. If the unit powers down while playing, we suggest changing the batteries.

# ACTIVITIES

## JJ's Family Car

### 1. JJ Character Button

Press the JJ character button to hear sounds, songs and phrases. A flashing light will accompany the responses.

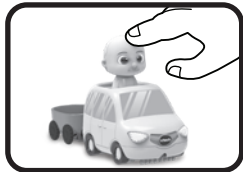

## 2. SmartPoint™ Locations

For added fun, **JJ's Family Car** interacts with the **CoComelon™ Toot-Toot Drivers® JJ's House Track Set**. Simply place the vehicle on one of the three **SmartPoint™** locations to see the car's lights flash and to hear fun sounds and music from the show. The car even interacts with other **Toot-Toot Drivers®** playsets (sold separately).



## JJ's House Track Set

### 1. SmartPoint™ Launcher

Put **JJ's Family Car** in the **SmartPoint™ Launcher**. Release and watch it slide to the bottom.



### 2. Front Door and Cody

Open the **Front Door** and Mum will wave to welcome you. Slide **Cody** and his cardboard box for more fun.



### 3. Garage Door

Lift the **Garage Door** to park **JJ's Family Car**.



# MELODY LIST

1. Nap Time Song
2. If You're Happy and You Know It
3. My Dog
4. Apples and Bananas
5. Where, Oh Where Has My Little Dog Gone?
6. Yes, Yes Bedtime

## SONG LYRICS

### Song 1

Clean up, clean up,  
We all had fun today,  
Now it's time to clean up and  
Put everything away!

### Song 2

Daddy Finger, Daddy Finger, Where Are You?

### Song 3

Peek-a-Boo  
Peek-a-Boo  
Peek-a-Boo  
Peek-a-Boo  
Peek-a-Boo  
Peek-a-Boo  
I got you!

### Song 4

When you say something you want,  
What's the magic word?  
Mmm...  
Please, please, please!



## Song 5

Hello, Hello, Hello, Hello, Hello.

Nice to meet you.

Nice to meet you.

Say Hello

## CARE & MAINTENANCE

1. Keep the unit clean by wiping it with a slightly damp cloth.
2. Keep the unit out of direct sunlight and away from any direct heat sources.
3. Remove the batteries if the unit will not be in use for an extended period of time.
4. Do not drop the unit on hard surfaces and do not expose the unit to moisture or water.

## TROUBLESHOOTING

If for some reason the unit stops working or malfunctions, please follow these steps:

1. Please turn the unit **OFF**.
2. Interrupt the power supply by removing the batteries.
3. Let the unit stand for a few minutes, then replace the batteries.
4. Turn the unit **ON**. The unit should now be ready to play again.
5. If the product still does not work, replace with an entire set of new batteries.

If the problem persists, please contact our Consumer Services Department and a service representative will be happy to help you.

# CONSUMER SERVICES

Creating and developing **VTech®** products is accompanied by a responsibility that we at **VTech®** take very seriously. We make every effort to ensure the accuracy of the information, which forms the value of our products. However, errors sometimes can occur. It is important for you to know that we stand behind our products and encourage you to call our Consumer Services Department with any problems and/or suggestions that you might have. A service representative will be happy to help you.

## **UK Customers:**

Phone: 0330 678 0149 (from UK) or +44 330 678 0149 (outside UK)  
Website: [www.vtech.co.uk/support](http://www.vtech.co.uk/support)

## **Australian Customers:**

Phone: 1800 862 155  
Website: [support.vtech.com.au](http://support.vtech.com.au)

## **NZ Customers:**

Phone: 0800 400 785  
Website: [support.vtech.com.au](http://support.vtech.com.au)

# PRODUCT WARRANTY/ CONSUMER GUARANTEES

## **UK Customers:**

Read our complete warranty policy online at [vtech.co.uk/warranty](http://vtech.co.uk/warranty).

## **Australian Customers:**

VTECH ELECTRONICS (AUSTRALIA) PTY LIMITED –  
CONSUMER GUARANTEES

Under the Australian Consumer Law, a number of consumer guarantees apply to goods and services supplied by VTech Electronics (Australia) Pty Limited. Please refer to [vtech.com.au/consumerguarantees](http://vtech.com.au/consumerguarantees) for further information.

**Visit our website for more  
information about our products,  
downloads, resources and more.**

***[www.vtech.co.uk](http://www.vtech.co.uk)***  
***[www.vtech.com.au](http://www.vtech.com.au)***



CoComelon™ & © 2022 Moonbug Entertainment.  
TM & © 2022 VTech Holdings Limited.  
All rights reserved.  
IM-557900-001  
Version:0